

2

1

APPLICATION

REVISIONS

NEXT ASS'Y	USED ON	VAR

REV	DESCRIPTION	ECN	APP'D
NR	RELEASED TO DRAFTING		DM 6/01
A	ADDED MOUNTING STUD	25111	ECB 10/16/06

16500

PCB Piezotronics Inc. claims proprietary rights in the information disclosed herein. Neither it nor any reproduction thereof will be disclosed to others without the written consent of PCB Piezotronics Inc.

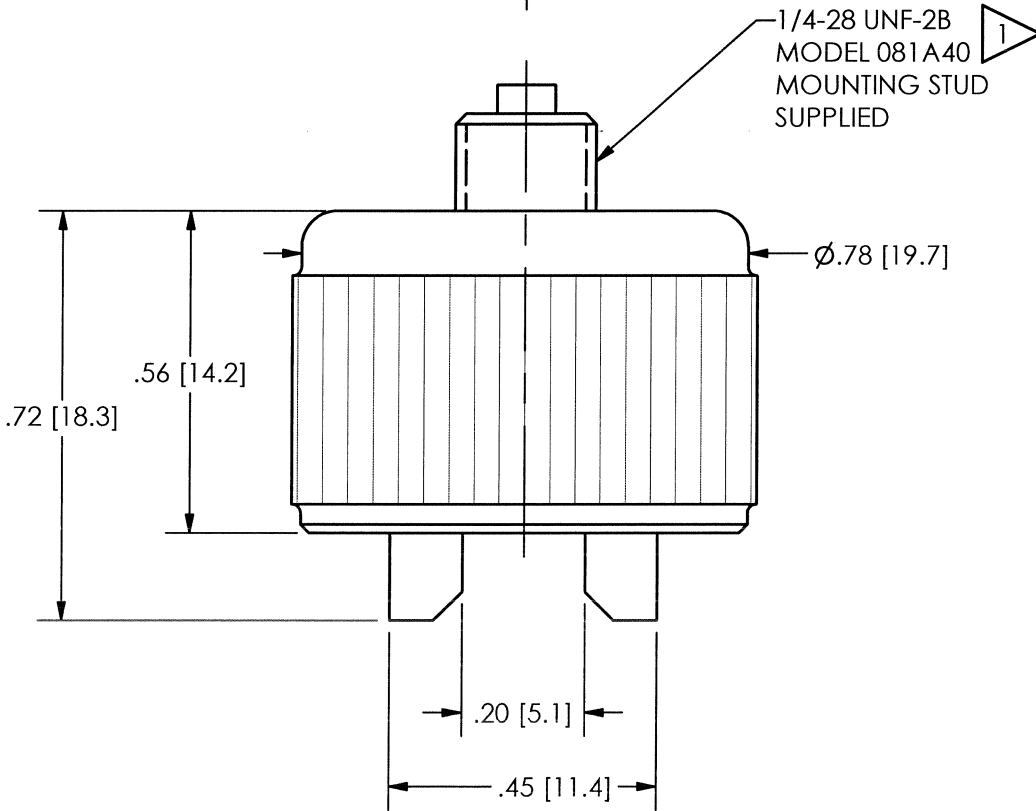
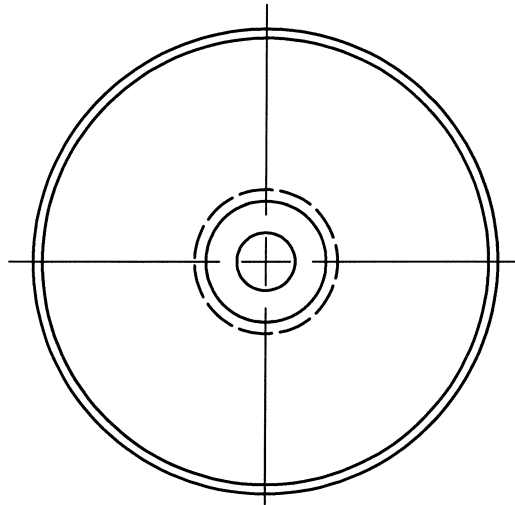

2.) PULL STRENGTH = 15 LBS

1 MODEL M080A130: THREAD IS M6 X 1.0 6H AND MOUNTING STUD M081A61 REPLACES 081A40.

UNLESS OTHERWISE SPECIFIED TOLERANCES ARE:

DIMENSIONS IN INCHES

DECIMALS XX ± .03
 XXX ± .010
 ANGLES ± 2 DEGREES

DIMENSIONS IN MILLIMETERS [IN BRACKETS]

DECIMALS X ± 0.8
 XX ± 0.25
 ANGLES ± 2 DEGREES

FILLETS AND RADII .003 - .005

FILLETS AND RADII [0.07 - 0.13]

DRAWN	<i>Jan</i> 10/16/06	MFG	<i>P. D. D'Amico</i>
CHK'D	<i>ECB</i> 10/16/06	ENGR	<i>MW</i> 10/16/06
APP'D	<i>N.F.</i> 10/16/06	SALES	<i>GRM</i> 10/16/06

PCB PIEZOTRONICS^{INC.}
 3425 WALDEN AVE. DEPEW, NY 14043
 (716) 684-0001 E-MAIL: sales@pcb.com

TITLE
 OUTLINE DRAWING
 MODEL 080A130, M
 CURVED SURFACE MAGNET

CODE IDENT. NO. 52681	DWG. NO. 16500
SCALE: 3X	SHEET 1 OF 1

2

1

1