

Repair and Maintenance

PCB guarantees Total Customer Satisfaction through its “Lifetime Warranty Plus” on all Platinum Stock Products sold by PCB and through its limited warranties on all other PCB Stock, Standard and Special products. Due to the sophisticated nature of our sensors and associated instrumentation, **field servicing and repair is not recommended and, if attempted, will void the factory warranty.**

Beyond routine calibration and battery replacements where applicable, our products require no user maintenance. Clean electrical connectors, housings, and mounting surfaces with solutions and techniques that will not harm the material of construction. Observe caution when using liquids near devices that are not hermetically sealed. Such devices should only be wiped with a dampened cloth—never saturated or submerged.

In the event that equipment becomes damaged or ceases to operate, our Application Engineers are here to support your troubleshooting efforts 24 hours a day, 7 days a week. Call or email with model and serial number as well as a brief description of the problem.

Calibration

Routine calibration of sensors and associated instrumentation is necessary to maintain measurement accuracy. We recommend calibrating on an annual basis, after exposure to any extreme environmental influence, or prior to any critical test.

PCB Piezotronics is an ISO-9001 certified company whose calibration services are accredited by A2LA to ISO/IEC 17025, with full traceability to SI through N.I.S.T. In addition to our standard calibration services, we also offer specialized tests, including: sensitivity at elevated or cryogenic temperatures, phase response, extended high or low frequency response, extended range, leak testing, hydrostatic pressure testing, and others. For more information, contact your local PCB Piezotronics distributor, sales representative, or factory customer service representative.

Returning Equipment

If factory repair is required, our representatives will provide you with a Return Material Authorization (RMA) number, which we use to reference any information you have already provided and expedite the repair process. This number should be clearly marked on the outside of all returned package(s) and on any packing list(s) accompanying the shipment.

Contact Information

PCB Piezotronics, Inc.
3425 Walden Ave.
Depew, NY14043 USA
Toll-free: (800) 828-8840
24-hour SensorLine: (716) 684-0001
General inquiries: info@pcb.com
Repair inquiries: rma@pcb.com

For a complete list of distributors, global offices and sales representatives, visit our website, www.pcb.com.

Safety Considerations

This product is intended for use by qualified personnel who recognize shock hazards and are familiar with the precautions required to avoid injury. While our equipment is designed with user safety in mind, the protection provided by the equipment may be impaired if equipment is used in a manner not specified by this manual.

Discontinue use and contact our 24-Hour Sensorline if:

- Assistance is needed to safely operate equipment
- Damage is visible or suspected
- Equipment fails or malfunctions

For complete equipment ratings, refer to the enclosed specification sheet for your product.

Definition of Terms and Symbols

The following symbols may be used in this manual:



DANGER

Indicates an immediate hazardous situation, which, if not avoided, may result in death or serious injury.

**CAUTION**

Refers to hazards that could damage the instrument.

**NOTE**

Indicates tips, recommendations and important information. The notes simplify processes and contain additional information on particular operating steps.

The following symbols may be found on the equipment described in this manual:



This symbol on the unit indicates that high voltage may be present. Use standard safety precautions to avoid personal contact with this voltage.



This symbol on the unit indicates that the user should refer to the operating instructions located in the manual.



This symbol indicates safety, earth ground.



PCB工业监视和测量设备 - 中国RoHS2公布表

PCB Industrial Monitoring and Measuring Equipment - China RoHS 2 Disclosure Table

部件名称	有害物质					
	铅 (Pb)	汞 (Hg)	镉 (Cd)	六价铬 (Cr(VI))	多溴联苯 (PBB)	多溴二苯醚 (PBDE)
住房	O	O	O	O	O	O
PCB板	X	O	O	O	O	O
电气连接器	O	O	O	O	O	O
压电晶体	X	O	O	O	O	O
环氧	O	O	O	O	O	O
铁氟龙	O	O	O	O	O	O
电子	O	O	O	O	O	O
厚膜基板	O	O	X	O	O	O
电线	O	O	O	O	O	O
电缆	X	O	O	O	O	O
塑料	O	O	O	O	O	O
焊接	X	O	O	O	O	O
铜合金/黄铜	X	O	O	O	O	O
本表格依据 SJ/T 11364 的规定编制。						
O：表示该有害物质在该部件所有均质材料中的含量均在 GB/T 26572 规定的限量要求以下。						
X：表示该有害物质至少在该部件的某一均质材料中的含量超出 GB/T 26572 规定的限量要求。						
铅是欧洲RoHS指令2011/65/ EU附件三和附件四目前由于允许的豁免。						

CHINA RoHS COMPLIANCE

Component Name	Hazardous Substances					
	Lead (Pb)	Mercury (Hg)	Cadmium (Cd)	Chromium VI Compounds (Cr(VI))	Polybrominated Biphenyls (PBB)	Polybrominated Diphenyl Ethers (PBDE)
Housing	O	O	O	O	O	O
PCB Board	X	O	O	O	O	O
Electrical Connectors	O	O	O	O	O	O
Piezoelectric Crystals	X	O	O	O	O	O
Epoxy	O	O	O	O	O	O
Teflon	O	O	O	O	O	O
Electronics	O	O	O	O	O	O
Thick Film Substrate	O	O	X	O	O	O
Wires	O	O	O	O	O	O
Cables	X	O	O	O	O	O
Plastic	O	O	O	O	O	O
Solder	X	O	O	O	O	O
Copper Alloy/Brass	X	O	O	O	O	O

This table is prepared in accordance with the provisions of SJ/T 11364.

O: Indicates that said hazardous substance contained in all of the homogeneous materials for this part is below the limit requirement of GB/T 26572.

X: Indicates that said hazardous substance contained in at least one of the homogeneous materials for this part is above the limit requirement of GB/T 26572.

Lead is present due to allowed exemption in Annex III or Annex IV of the European RoHS Directive 2011/65/EU.

Model Number 630A91	INDUSTRIAL TRIAXIAL ICP® ACCELEROMETER			Revision: A ECN #: 50951
Performance	ENGLISH	SI		OPTIONAL VERSIONS
Sensitivity(± 10 %)	100 mV/g	10.2 mV/(m/s ²)	[1]	Optional versions have identical specifications and accessories as listed for the standard model except where noted below. More than one option may be used.
Measurement Range	± 50 g	± 490.5 m/s ²		
Frequency Range(+/- 3 dB)(z axis)	120 to 600,000 cpm	2 to 10,000 Hz	[2][3]	
Frequency Range(+/- 3 dB)(x or y axis)	120 to 420,000 cpm	2 to 7,000 Hz		
Non-Linearity	± 1 %	± 1 %	[4]	
Broadband Resolution(1 to 10,000 Hz)	560 µg	5,694 µm/sec ²	[5]	
Resonant Frequency	1,020 kcpm	17 kHz	[5]	
Transverse Sensitivity	≤ 7 %	≤ 7 %		
Environmental				
Overload Limit(Shock)	5,000 g pk	49,050 m/s ² pk		
Temperature Range	-65 to +250 °F	-54 to +121 °C		
Temperature Response	See Graph	See Graph	[5]	
Enclosure Rating	IP68	IP68		
Electrical				
Settling Time(within 1% of bias)	≤ 3.0 sec	≤ 3.0 sec		
Discharge Time Constant	≥ 0.1 sec	≥ 0.1 sec		
Excitation Voltage	18 to 28 VDC	18 to 28 VDC		
Constant Current Excitation	2 to 20 mA	2 to 20 mA		
Output Impedance	< 350 Ohm	< 350 Ohm		
Output Bias Voltage	8 to 12 VDC	8 to 12 VDC		
Spectral Noise(10 Hz)	40 µg/√Hz	392 (µm/sec ²)/√Hz	[5]	
Spectral Noise(100 Hz)	10 µg/√Hz	98.1 (µm/sec ²)/√Hz	[5]	
Spectral Noise(1 kHz)	6 µg/√Hz	58.9 (µm/sec ²)/√Hz	[5]	
Electrical Isolation	> 10 ⁸ Ohm	> 10 ⁸ Ohm		
Electrical Protection	RFI/ESD	RFI/ESD		
Physical				
Size (Diameter x Height)	1.49 in x 1.23 in	37.9 mm x 31.3 mm		
Weight	4.22 oz	119.7 gm	[5]	
Mounting	Through Hole	Through Hole		
Mounting Torque(Through Bolt)	2 to 5 ft-lb	2.7 to 6.8 N-cm		
Sensing Element	Ceramic	Ceramic		
Sensing Geometry	Shear	Shear		
Housing Material	Stainless Steel	Stainless Steel		
Sealing	Welded Hermetic	Welded Hermetic		
Electrical Connector	M12, 4-Pin	M12, 4-Pin		
Electrical Connection Position	Top	Top		
Electrical Connections(Pin 1)	X axis	X axis		
Electrical Connections(Chrome-Plated Brass)	Y axis	Y axis		
Electrical Connections(Pin 3)	Z axis	Z axis		
Electrical Connections(Pin 4)	Ground	Ground		

Typical Sensitivity Deviation vs Temperature

All specifications are at room temperature unless otherwise specified.
In the interest of constant product improvement, we reserve the right to change specifications without notice.
ICP® is a registered trademark of PCB Piezotronics, Inc.

NOTES:
[1]Conversion Factor 1g = 9.81 m/s².
[2]1Hz = 60 cpm (cycles per minute).
[3]The high frequency tolerance is accurate within ±10% of the specified frequency.
[4]Zero-based, least-squares, straight line method.
[5]Typical.
[6]See PCB Declaration of Conformance PS023 for details.

SUPPLIED ACCESSORIES:
Model 081A126 Mounting Bolt 10-32x.93" (Mating Guide) (1)
Model 54102-01 Locator Pin 5mm OD x 5.8mm long (1)
Model ICS-7 NIST traceable triaxial amplitude response calibration from 10 Hz to upper +/-3dB point.

Entered: LK	Engineer: GD	Sales: MC	Approved: BAM	Spec Number:
Date: 07/29/2020	Date: 07/29/2020	Date: 07/29/2020	Date: 07/29/2020	73114

IMI SENSORS
A PCB PIEZOTRONICS DIV.
3425 Walden Avenue, Depew, NY 14043

Phone: 800-959-4464
Fax: 716-684-3823
E-Mail: imi@pcb.com

PCB Piezotronics Inc. claims proprietary rights in the information disclosed hereon. Neither it nor any reproduction thereof will be disclosed to others without the written consent of PCB Piezotronics Inc.

REVISIONS

REV	DESCRIPTION	DIN
NR	RELEASED TO DRAFTING	50834

73353

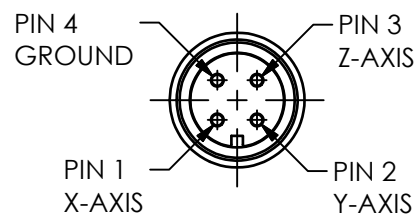
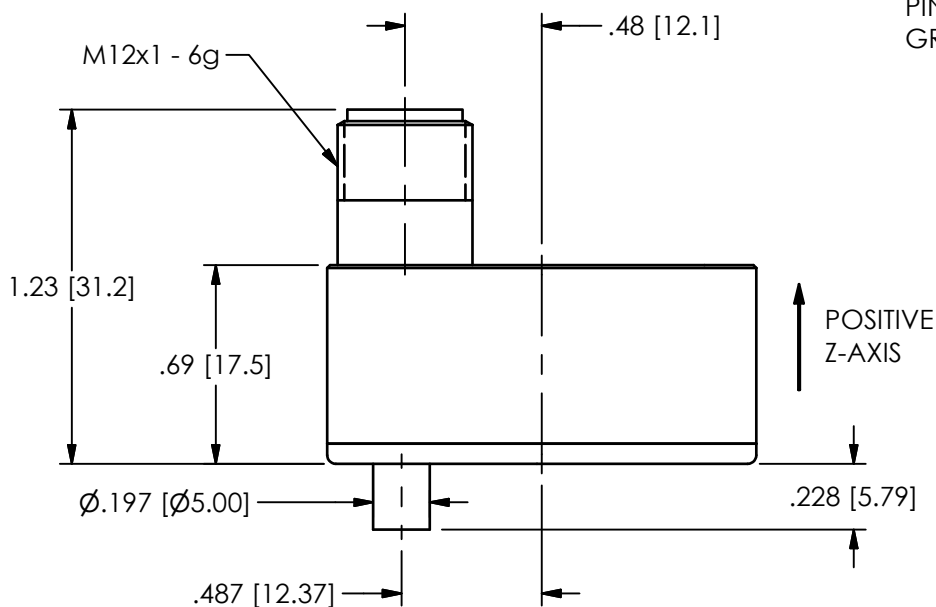
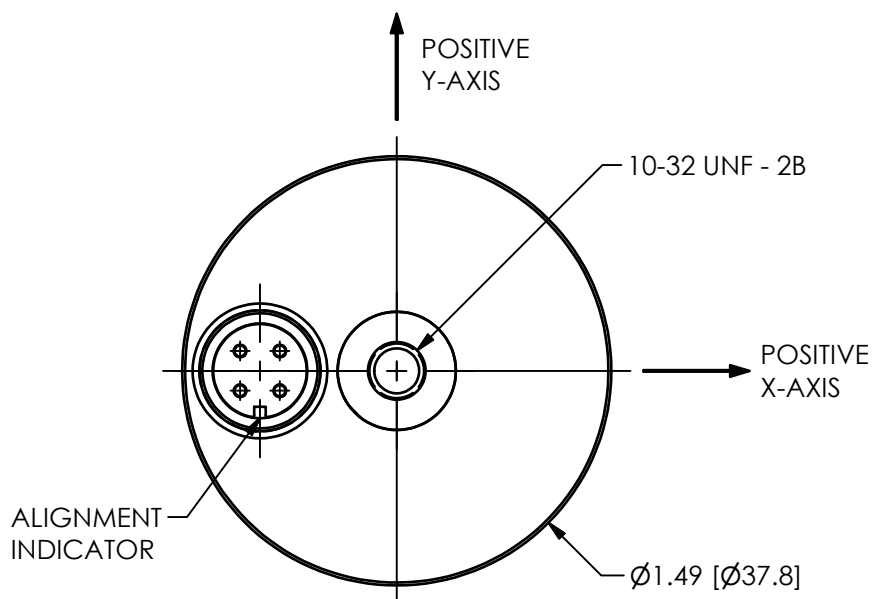

PIN OUT

UNLESS OTHERWISE SPECIFIED TOLERANCES ARE:

DIMENSIONS IN INCHES

DECIMALS XX ±.03
XXX ±.010

ANGLES ± 2 DEGREES

FILLETS AND RADII
.003 - .005

DIMENSIONS IN MILLIMETERS
[IN BRACKETS]

DECIMALS X ± 0.8
XX ± 0.25

ANGLES ± 2 DEGREES

FILLETS AND RADII
0.07 - 0.13

DRAWN

KSR 6/29/20

CHECKED

KSR 6/29/20

ENGINEER

GCD 6/29/20

TITLE

OUTLINE DRAWING
CASE ISOLATED TRIAXIAL
ACCELEROMETER W/M12 CONN

PCB PIEZOTRONICS™

3425 WALDEN AVE. DEPEW, NY 14043
(716) 684-0001 E-MAIL: sales@pcb.com

CODE
IDENT. NO.
52681

DWG. NO.

73353

SCALE: 1.5X

SHEET 1 OF 1